



**Test Report**

Number: 150910002SZN-001

Applicant: : Spector & Co.  
5700 Kieran Rd, Montreal,  
QC, H4S 2B5

Date: 9 Dec, 2015

Attn : productcompliance@spector  
andco.com

**Vend No** : Not provide

**Type of Product** : CHEER

**Brand** : SPECTECH

**Model No. of Product** : T802

**Country of Origin** : China **Date of Received** : Nov 09, 2015

**Date of test Conducted** : Sep 09, 2015~Nov 13, 2015

**Test Required** : Lead content & phthalate content.

**Sample Quantity** : 5 pieces

\*\*\*\*\*  
**Conclusion:**

<u>Tested samples</u>	<u>Standard</u>	<u>Result</u>
Tested components of submitted samples	Applicant's requirement for Lead content	Pass
Tested components of submitted samples	Applicant's requirement for phthalate content	Pass

\*\*\*\*\*  
**Remark:**

- Nil

\*\*\*\*\*  
Authorized by:  
For Intertek Testing Services Shenzhen Ltd.  
Kejiyuan Branch

-----  
Wisons Lin  
Team Leader

\*\*\*\*\*



**Test Report**

Number: 150910002SZN-001

◆ **1 Total Lead (Pb) Content in Surface Coating**

As per Standard Operating Procedure for Determining Lead (Pb) in paint and other similar surface coatings, test method CPSC-CH-E1003-09.1 was used and total Lead content was determined by Inductively Coupled Argon Plasma Spectrometry.

**Not applicable**

**Tested Components:** See component list in the last section of this report.

\*\*\*\*\*

◆ **2 Total Lead (Pb) Content**

As per Standard Operating Procedures for Determining total Lead (Pb) in children's products, test methods CPSC-CH-E1002-08.1 and/or CPSC-CH-E1001-08.1 were used and total Lead content was determined by Inductively Coupled Argon Plasma Spectrometry .

Test Component	Result (ppm)	Limit(ppm)
<u>(1+2+3)</u>	<10	100
<u>(4+5+6)</u>	<10	100
<u>(7)</u>	<10	100
<u>(8+9+10)</u>	<10	100
<u>(11+12)</u>	<10	100
<u>(13+14)</u>	<10	100
<u>(15+16+17)</u>	<10	100
<u>(18)</u>	31	100
<u>(19)</u>	<10	100
<u>(20)</u>	22	100

- ppm = part per million =mg/kg

**Tested Components:** See component list in the last section of this report.

\*\*\*\*\*



**Test Report**

Number: 150910002SZN-001

◆ **2 Phthalate Content**

By solvent extraction and Gas Chromatographic-Mass Spectrometric (GC-MS) analysis.

Test item	<u>Result (%)</u>						<u>Limit</u>
	<u>(1+2+3)</u>	<u>(4+5+6)</u>	<u>(8+9+10)</u>	<u>(11+12)</u>	<u>(13)</u>	<u>(14)</u>	<u>(%)</u>
Dibutyl phthalate (DBP)	<0.01	<0.01	<0.01	<0.01	<0.01	<0.01	0.1
Diethyl hexyl phthalate (DEHP)	<0.01	<0.01	<0.01	<0.01	<0.01	<0.01	0.1
Benzyl butyl phthalate (BBP)	<0.01	<0.01	<0.01	<0.01	<0.01	<0.01	0.1
Di-iso-decyl phthalate (DIDP)	<0.01	<0.01	<0.01	<0.01	<0.01	<0.01	0.1
Di-n-hexyl phthalate (DnHP)	<0.01	<0.01	<0.01	<0.01	<0.01	<0.01	0.1
Di-iso-nonyl phthalate (DINP)	<0.01	<0.01	<0.01	<0.01	<0.01	<0.01	0.1
Di-n-octyl phthalate (DNOP)	<0.01	<0.01	<0.01	<0.01	<0.01	<0.01	0.1

ND = Not detected

Detected Limit = 0.01%

**Tested Components:** See component list in the last section of this report.

\*\*\*\*\*

## Test Report

Number: 150910002SZN-001

### Component List:

1. Bright white plastic sheet.
2. Black plastic.
3. White plastic.
4. Snow-white plastic (washer).
5. White plastic (clip).
6. White plastic (connector).
7. Silver color plated coating on plastic (button).
8. White plastic excluding coating (button).
9. White plastic (handle).
10. Black plastic (handle).
11. Transparent plastic label with black printing (CE label).
12. White plastic (wire covering).
13. White plastic (plug).
14. Bright white plastic (plug).
15. Silver color metal.
16. Silver color metal (screw).
17. Silver color metal tube.
18. Silver color metal (plug).
19. Silver color metal tube (plug).
20. Silver color metal pin (plug).

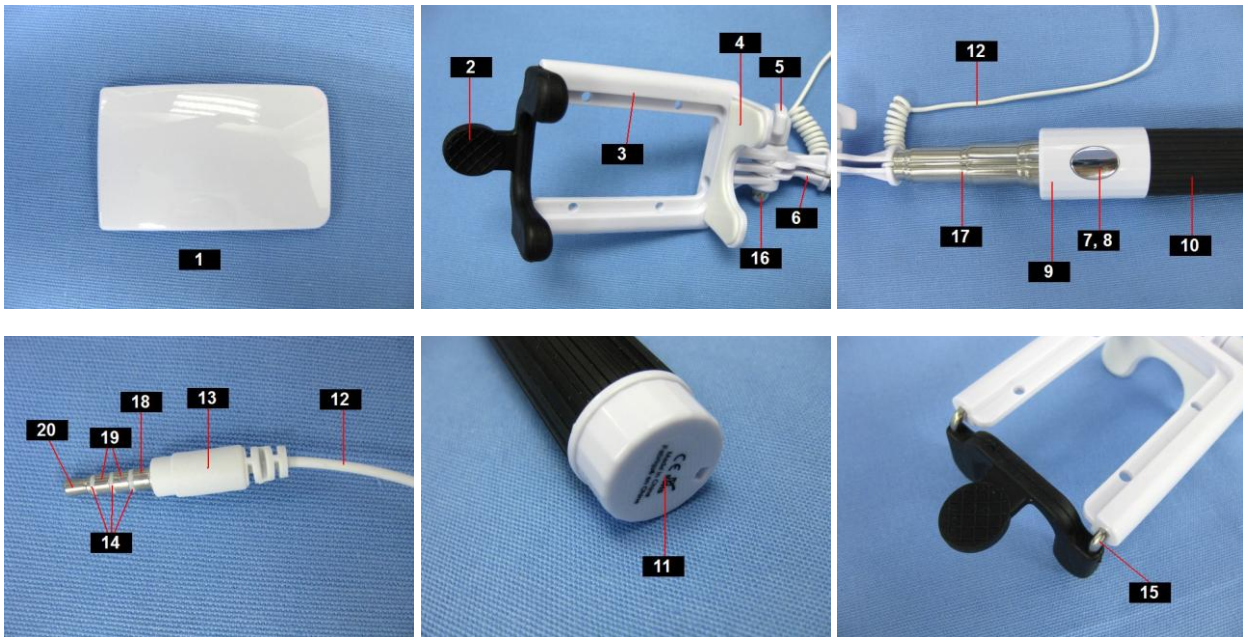

\*\*\*\*\*